

## DESCRIPTION

PMI MODEL P2T-1G18G-10-R-528-SFF-HIP10W IS A REFLECTIVE, SINGLE POLE, TWO THROW PIN DIODE SWITCH THAT OPERATES OVER THE 1.0 GHz TO 18.0 GHz FREQUENCY RANGE. THIS MODEL IS CAPABLE OF HANDLING AN INPUT POWER LEVEL OF 10 WATTS CW WHILE PROVIDING SWITCHING SPEEDS OF 100ns. THIS MODEL INCORPORATES A TTL COMPATIBLE DRIVER FOR EASY SYSTEM INTEGRATION.

## TYPICAL SPECIFICATIONS

- FREQUENCY RANGE:.....1.0 TO 18.0 GHz
- ISOLATION:.....10 dB Min
- INSERTION LOSS: .....4.0 dB Max; 3.0 dB GOAL
- VSWR IN / OUT: .....2.0:1
- OPERATING INPUT POWER:.....10 WATTS CW
- 1dB COMPRESSION:.....+40dBm GOAL
- RF SWITCHING SPEED:.....100ns GOAL
- IMPEDANCE: .....50 OHMS
- DC VOLTAGE: .....+5 V @ 20 mA  
-28 V @ 200mA
- CONTROL SIGNAL: .....TTL LOGIC  
SEE LOGIC TABLE
- CONNECTORS:.....SMA(F) - REMOVABLE
- CONTROL CONNECTORS:.....SOLDER PINS
- FINISH:.....PAINTED GRAY  
BOTTOM SIDE - UNPAINTED

## ENVIRONMENTAL RATINGS

- TEMPERATURE:.....-54°C TO +100°C (OPERATING)  
-55°C TO +125°C (STORAGE)
- SHOCK:.....MIL-STD-202F, METHOD 213B COND. B
- VIBRATION:.....MIL-STD-202F, METHOD 204D COND. B
- ALTITUDE:.....MIL-STD-202F, METHOD 105C COND. B
- TEMPERATURE CYCLE:.....MIL-STD-202F, METHOD 107

NOTE: SPECIFICATIONS WILL VARY OVER OPERATING TEMPERATURE  
NOTE: THE ABOVE SPECIFICATIONS ARE SUBJECT TO CHANGE OR REVISION

REVISIONS				
ZONE	REV.	DESCRIPTION	DATE	APPROVED
	A1	ORIGINAL RELEASE	11/30/11	
	B1	UPDATED TITLE BLOCK	03/15/13	
	B2	ECN # 13-0215	12/03/13	

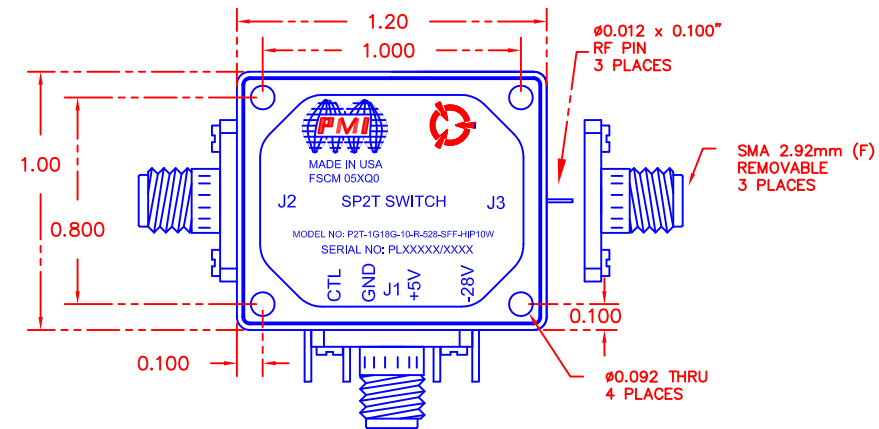

LOGIC TABLE

CTL	J1 - J2	J1 - J3
0	ON	OFF
1	OFF	ON

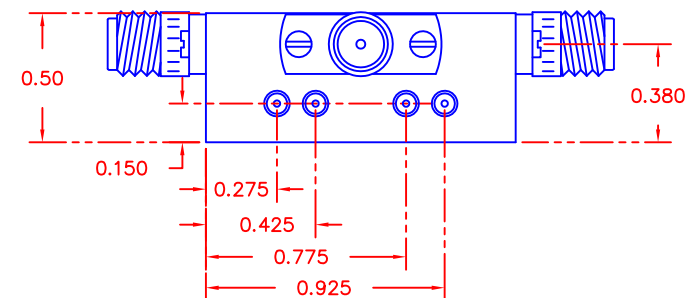

PMI CONFIDENTIAL AND PROPRIETARY

## PLANAR MONOLITHICS INDUSTRIES, INC.

7311-F GROVE ROAD  
FREDERICK, MARYLAND 21704 USA  
TEL: 301-662-5019 FAX: 301-662-1731  
WEBSITE: [www.pmi-rf.com](http://www.pmi-rf.com)  
E-MAIL: [sales@pmi-rf.com](mailto:sales@pmi-rf.com)  
ISO 9001 CERTIFIED



ALL DIMENSIONS ARE IN INCHES  
TOLERANCES:  
X.XX ±0.020  
X.XXX ±0.010

APPROVALS		DATE	TITLE		
DRAWN <i>JRR</i>		11/30/11	PRODUCT FEATURE		
CHECKED			P2T-1G18G-10-R-528-SFF-HIP10W		
ISSUED			SIZE	FSCM NO.	DWG NO.
			A	05XQ0	27015161-B
			SCALE N: S		REV. B2
			SHEET 1 OF 1		