

REVISIONS		DESCRIPTION	DATE	APPROVED
ZONE	REV.			
A		ORIGINAL RELEASE	9/4/09	

DESCRIPTION:

PW1 model number 4BP160-20-2A-PP is a LC Bandpass filter with PC Pins in and out.

SPECIFICATIONS:

- CENTER FREQUENCY: 160 MHz
- 3dB BANDWIDTH: 20 MHz, ± 5%
- VSWR IN THE PASS BAND: 1.5:1 MAX.
- INSERTION LOSS (PASSBAND) 5 dB, NOMINAL
- REJECTION 4 Section Response

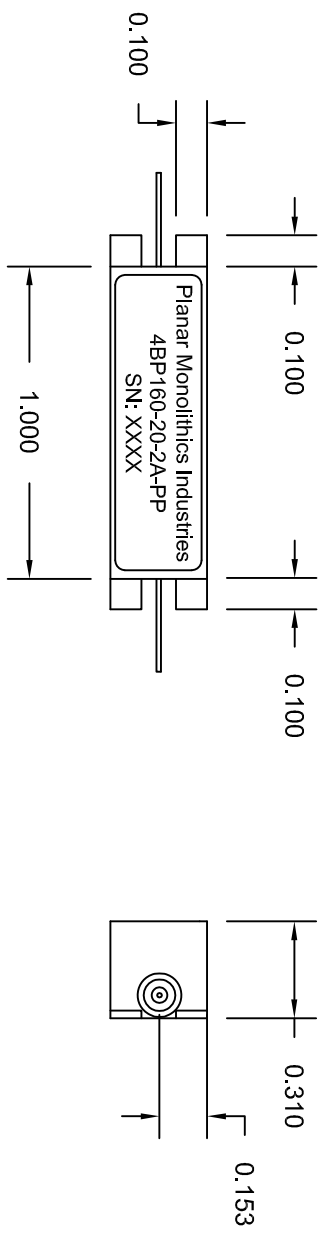

- CONNECTORS: PC PINS IN/OUT
- SIZE 1.20" (L) x 0.31" (W) x 0.31" (H)
- WEIGHT 1 OZ. TYP.

ENVIRONMENTAL RATINGS:

- TEMPERATURE: -55°C TO +85°C (OPERATING)
-65°C TO +125°C (STORAGE)
- HUMIDITY: MIL-STD-202F, METHOD 103B COND. B
- SHOCK: MIL-STD-202F, METHOD 213B COND. B
- VIBRATION: MIL-STD-202F, METHOD 204D COND. B
- ALTITUDE: MIL-STD-202F, METHOD 105C COND. B
- SALT FOG: MIL-STD-202F, METHOD 107D COND. A
- FUNGUS: MIL-STD-810C, METHOD 508.2
- TEMPERATURE CYCLE: MIL-STD-202F, METHOD 107

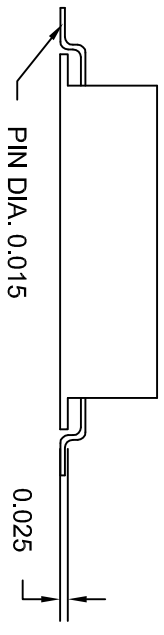

ALL DIMENSIONS ARE IN INCHES
TOLERANCES:
X.XX ±0.010
X.XXX ±0.005

NOTE: THE ABOVE SPECIFICATIONS ARE SUBJECT TO CHANGE OR REVISION

PART NO.	APPROVALS	DATE	TITLE	PLANAR MONOLITHICS INDUSTRIES 5715 INDUSTRIAL PARK, SUITE 11 FREDERICK, MARYLAND
DRAWN S. PALACIO		9/4/09	OUTLINE DRAWING 4BP160-20-2A-PP	
ISSUED	CHECKED		SIZE FSQM NO. A 05X00	DWG NO. 27008483
			SCALE N/A	SHEET 1 OF 1
				REV. -